



# INSTALLATION INSTRUCTIONS

## LR100AREXK

### ADAMS RITE ELECTRIC LATCH RETRACTION DEVICE KIT

#### MODELS: EX88, EX89 & EX76

### RIM KIT INSTALLATION

**ELECTRICAL DATA**  
24VDC +/- 10%  
1.5A inrush/200mA holding  
RED (+)      BLK (-)  
PATENT #8,851,530

#### STEP 1

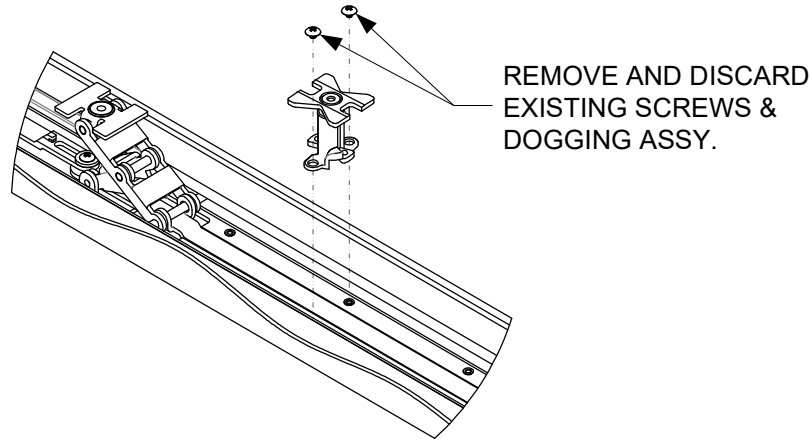

#### STEP 2

ATTACH THE LINKAGE  
BRACKETS TO THE  
LR100AREXK AS  
SHOWN

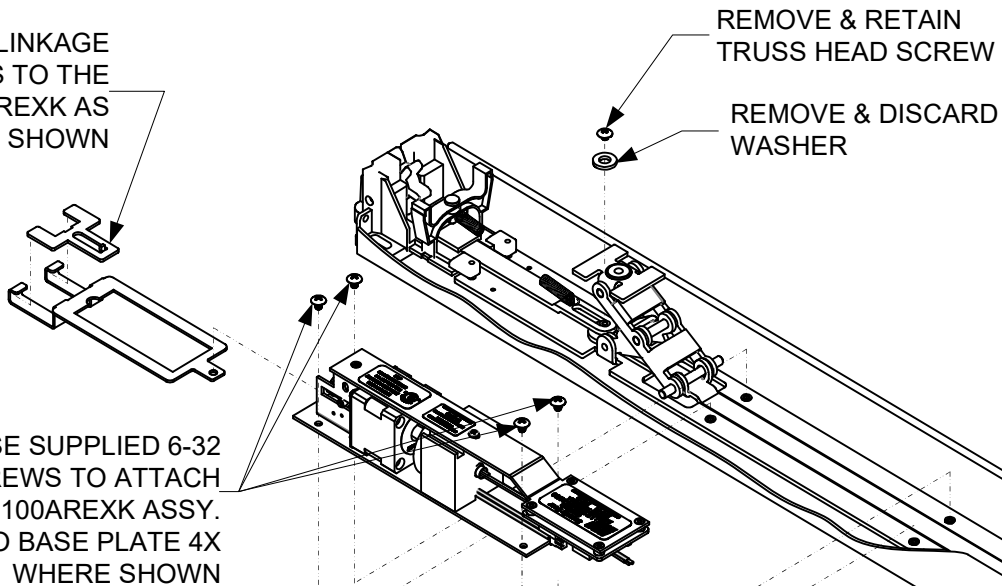

REPLACE TRUSS HEAD SCREW

Any suggestions or comments to this instruction or product are welcome. Please contact us through our website or email [engineer@sdsecurity.com](mailto:engineer@sdsecurity.com)

## VERTICAL ROD KIT INSTALLATION

### STEP 1

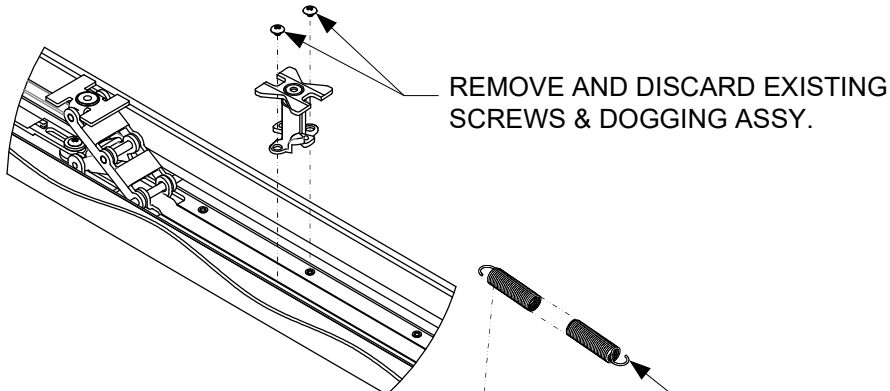

### STEP 2

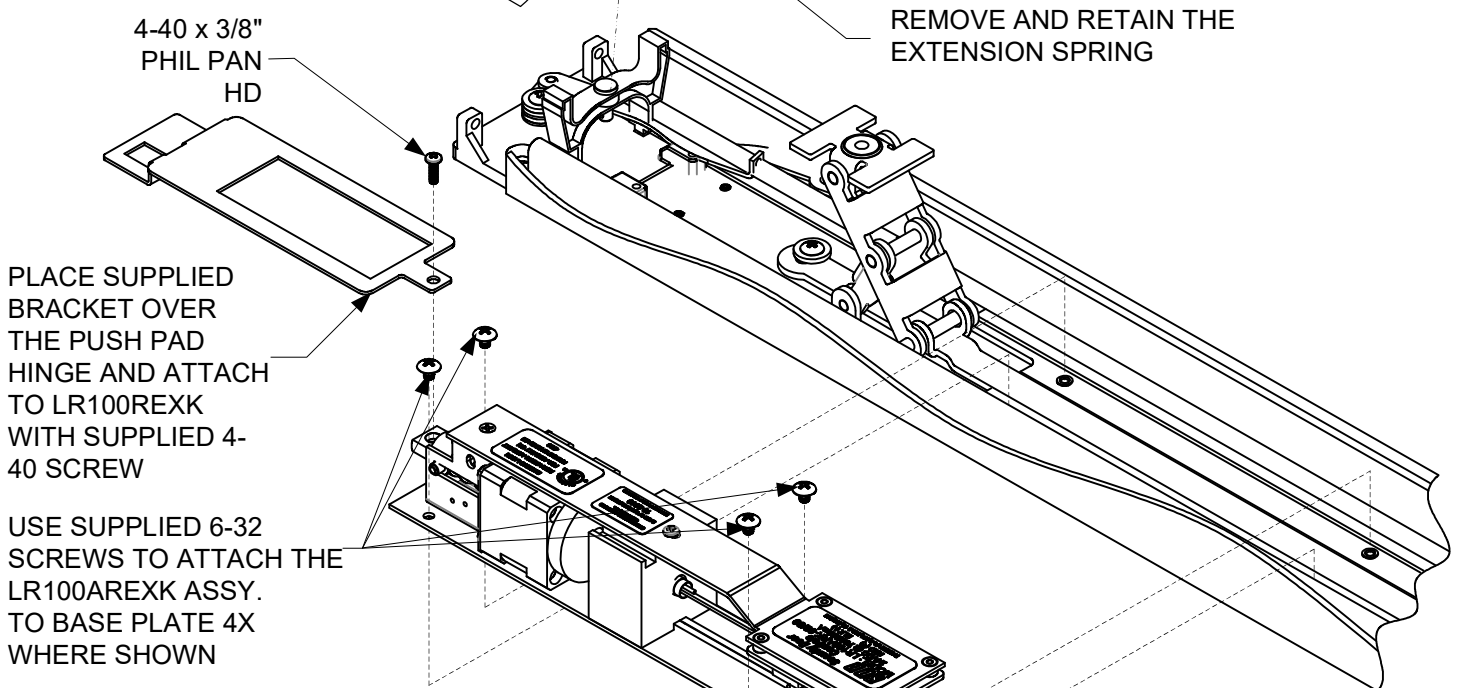

### STEP 3

REPLACE THE EXTENSION SPRING

This diagram shows the final step of the installation, where the extension spring is reattached to the handle assembly.

When retrofitting to existing vertical rod devices, adjustment of the rods is required for proper operation of the Electric Latch Retractor. Once the unit is properly installed, energize it so the latch is dogged down, then reconnect the vertical rods to the device and make the proper adjustments to the rods.